

9 Netherwood, Bradford, BD13 4NR

£310,000

- SPACIOUS DETACHED PROPERTY
- UTILITY & GROUND FLOOR WC
- BACKING ON TO OPEN FIELDS
- EARLY VIEWING IS ADVISED
- FOUR /FIVE BEDROOMS
- DOUBLE INTEGRAL GARAGE
- OFF-ROAD PARKING
- TWO/THREE RECEPTION ROOMS
- PRIVATE ENCLOSED GARDEN TO REAR
- CUL-DE-SAC LOCATION

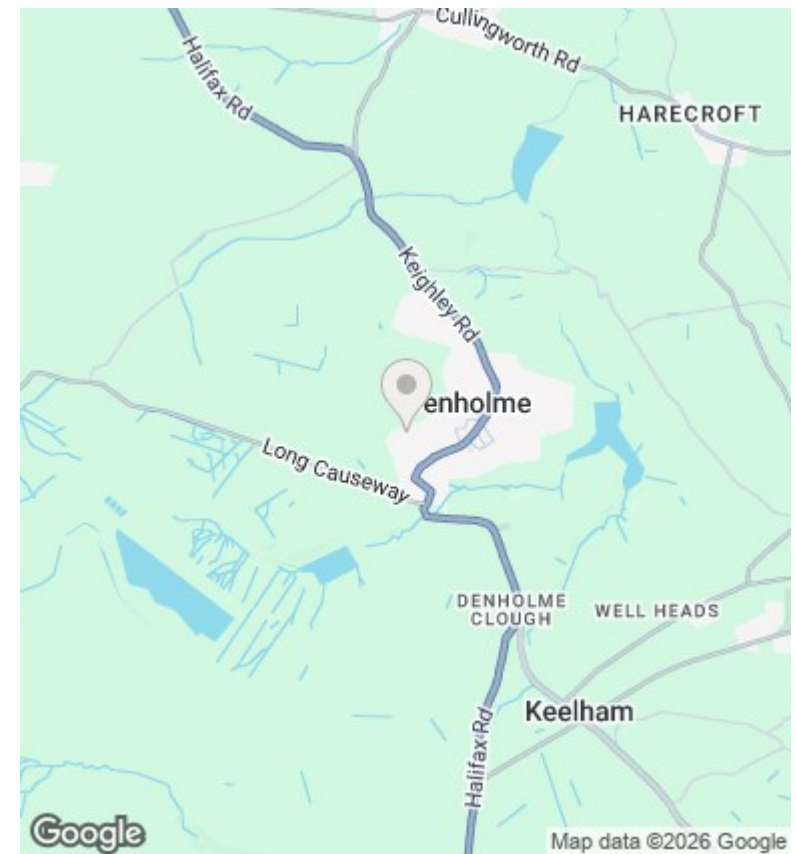
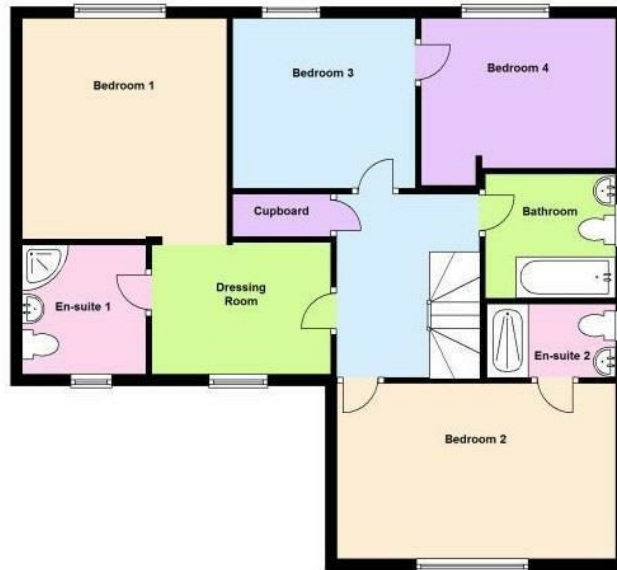

Directions

Viewings

Viewings by arrangement only.
Call 01274884040 to make an appointment.

Council Tax Band

B

EPC Rating:

C

| Energy Efficiency Rating | | |
|---|-------------------------|-----------|
| | Current | Potential |
| Very energy efficient - lower running costs | | |
| (92 plus) A | | |
| (81-91) B | | |
| (69-80) C | 76 | 83 |
| (55-68) D | | |
| (39-54) E | | |
| (21-38) F | | |
| (1-20) G | | |
| Not energy efficient - higher running costs | | |
| England & Wales | EU Directive 2002/91/EC | |